

# CHROMATOGRAPH FITTINGS

## 961 L MALE NUT (INCH)

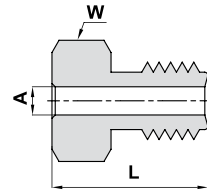

Ordering Information	A Tube O.D.		W Hex. Flat		L	
	inch	mm	inch	mm	inch	mm
961L_ 1/16	1/16	1.58	1/4		.38	9.50

## 962 L UNION (INCH)

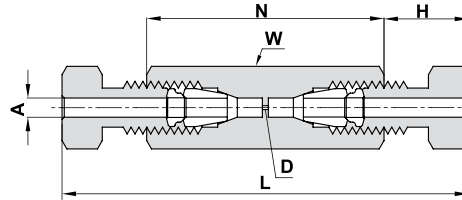

Ordering Information	A Tube O.D.		D		W Hex. Flat		N		H		L		Dead Space
	inch	mm	inch	mm	inch	mm	inch	mm	inch	mm	inch	mm	
962L_ 1/16	1/16	1.58	.013	.33	1/4		.84	21.34	.20	5.08	1.25	31.75	6.6 X 10 <sup>-5</sup> CC

## 963 L REDUCING UNION (INCH)

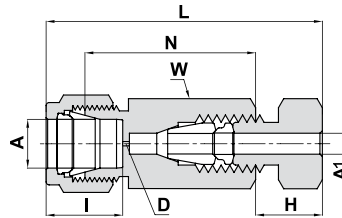

Ordering Information	A Tube O.D.		A1 Tube O.D.		D		W Hex. Flat		N		L		H		I		Dead Space
	inch	mm	inch	mm	inch	mm	inch	mm	inch	mm	inch	mm	inch	mm	inch	mm	
963L_ 1/4 X 1/16	1/4	6.35	1/16	1.58	.013	.33	1/2		.75	19.05	1.24	31.50	.20	5.08	.60	15.2	6.8 X 10 <sup>-5</sup> CC
963L_ 3/8 X 1/16	3/8	9.52	1/16	1.58	.013	.33	5/8		.81	20.57	1.30	33.02	.20	5.08	.66	16.8	6.8 X 10 <sup>-5</sup> CC

## 964 L UNION TEE (INCH)

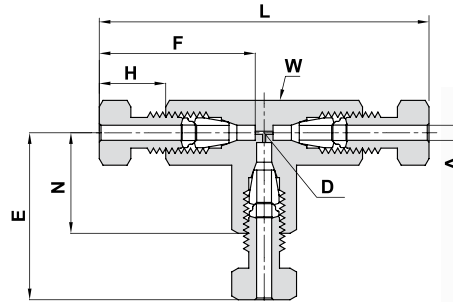

Ordering Information	A Tube O.D.		D		W Wrench Flat		N		H		F		E		L		Dead Space
	inch	mm	inch	mm	inch	mm	inch	mm	inch	mm	inch	mm	inch	mm	inch	mm	
964L_ 1/16	1/16	1.58	.013	.33	3/8	9.52	.45	11.43	.20	5.08	.61	15.49	.65	16.51	1.30	33.02	2.8 X 10 <sup>-4</sup> CC

"D" - Dimension is minimum opening. Dimensions are for reference only, and are subject to change without notice.